



Industrial Filters · Accumulators

Strainer Baskets

40.330-750/1100

43.331-751/1100

41.1-7

42.1-7

Filtration grade 10-10000µm

Filter area 936 cm²-58823 cm²

Application

Pre- and coarse filtration of lubricants, water based liquids and liquids in general.

For use in basket strainers and coarse filters.

Easy to clean due to basket design.

Re-usable.

Contamination remains inside strainer basket during filter service.

Design

Type 40. and 41.

Standard strainer basket for filter types DLW and DFLW (Type 40.) as well as G, DG, GB and DGB (Type 41.). The strainer basket consist of wire mesh made of stainless steel plain dutch weave welded to a supporting core.

Type 42. and 43.

Strainer basket like version 40. and 41. with pleated wire mesh for enhanced filter area and larger service time.

Fig. 1
Strainer basket/
Strainer basket pleated version

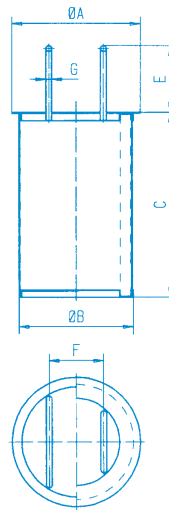
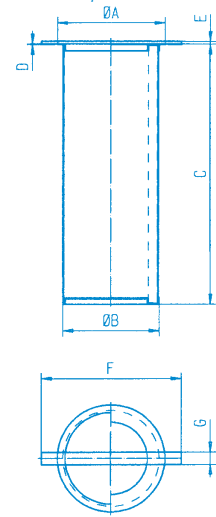

Fig. 2
Strainer basket/
Strainer basket pleated version



Dimensions for Fig. 1

Type	Filter	Area in cm ²	øA	øB	C	E	F	G
40.330	DLW DFLW	936	140	120	240	49	80	8
40.500		1278	174	159	250	91		
40.750		1896			370			
40.750/1100		2977	580					
43.331		2228	140	120	240	49	74	
43.501		3545	174	155	250	91		
43.751		5270			370			
43.751/1100		8295	580					

Dimensions for Fig. 2

Type	Filter	Area in cm ²	øA	øB	C	D	E	F	G
41.1	G DG GB DGB	1665	173	155	334,5	1,5	4	225	20
41.2		2500			501,5				
41.3		3330			667,5				
41.4		5000			1001,5				
41.5		5000	503	343	315	3	6	420	25
41.6		6660	669						
41.7		10000	1003						
42.1		7370	334,5						
42.2		1890	501,5	173	155	1,5	4	225	20
42.3		14390	667,5						
42.4		20832	1001,5						
42.5		29323	503						
42.6		39117	669	343	315	3	6	420	25
42.7		58823	1003						

Dimension "F" = 220 only for strainer size 41.1-4 and 42.1-4

K. & H. Eppensteiner GmbH & Co. KG
Hardtwaldstraße 43 · D-68775 Ketsch
P.O. Box 1120 · D-68768 Ketsch
Phone: +49 62 02/6 03-0
Telefax: +49 62 02/6 03-199
E-Mail: info@eppensteiner.de
Internet: www.eppensteiner.de



Quality assured!

Ordering Information

Element Type	Nominal Size	Filtration Grade	Differential Pressure	Filter Element Design	Bypass Valve	Seal	Add. Info
40.	For filter with strainer 330-750/1100 1100; 2100; 3000; 5000	G10 G130 G550 G25 G200 G600 G40 G250 G800	S = Standard (serial)	O... = Standard without adhesive	0 = Without	0=Without	0 = Without Z = Certificates
41.	For wide meshed filter 1-7	G60 G300 G1000 G80 G350 G1500 G100 G450 G2000		...O = Standard material only for 41. und 42. ...C = Stainless steel 1.4301 ...V = Stainless steel 1.4571 ...D = Nickel plated ...Z = Zinc free			
42.	For wide meshed filter pleated version 1-7	L3000 L5000 L8000 L10000		For temp. > 100° C please call back			
43.	For filter with strainer pleated version 331-751/1100						

Maintenance Instruction

Maintenance

Strainer baskets can only withstand a low differential pressure. Therefore don't overcharge strainer basket and service filter when maintenance indicator is activated to prevent from damage. The strainer basket is clogged and needs to be cleaned if the visual indicator's red pin reaches its final position and/or the electrical switch is activated.

In machines with centrifugal pumps the strainer basket is clogged if the flow rate or the pressure drops to a defined value.

Replacement of strainer basket

Switch off pump, open vent valve at filter housing and depressurise system. Open filter and remove strainer basket from housing.

Check condition of wire mesh inside strainer. Replace strainer in case of wire mesh damage.

Clean strainer basket using a suitable solvent and a smooth brush or by using a pressurised cleaner. Clean the strainer basket's sealing surface inside filter housing.

Insert cleaned strainer basket. Close cover and switch on system pump. De-aerate filter by opening vent valve until liquid emerges and close again.

Performance Characteristics

Δp -Q characteristics

kinematic viscosity: 10 mm²/s

